

Unter Haßlen 20 · D-78532 Tuttlingen
Phone: +49 (0)7462/9470-0
Fax: +49 (0)7462/9470-50
e-mail: sales@rz-medizintechnik.com
<http://www.rz-medizintechnik.com>

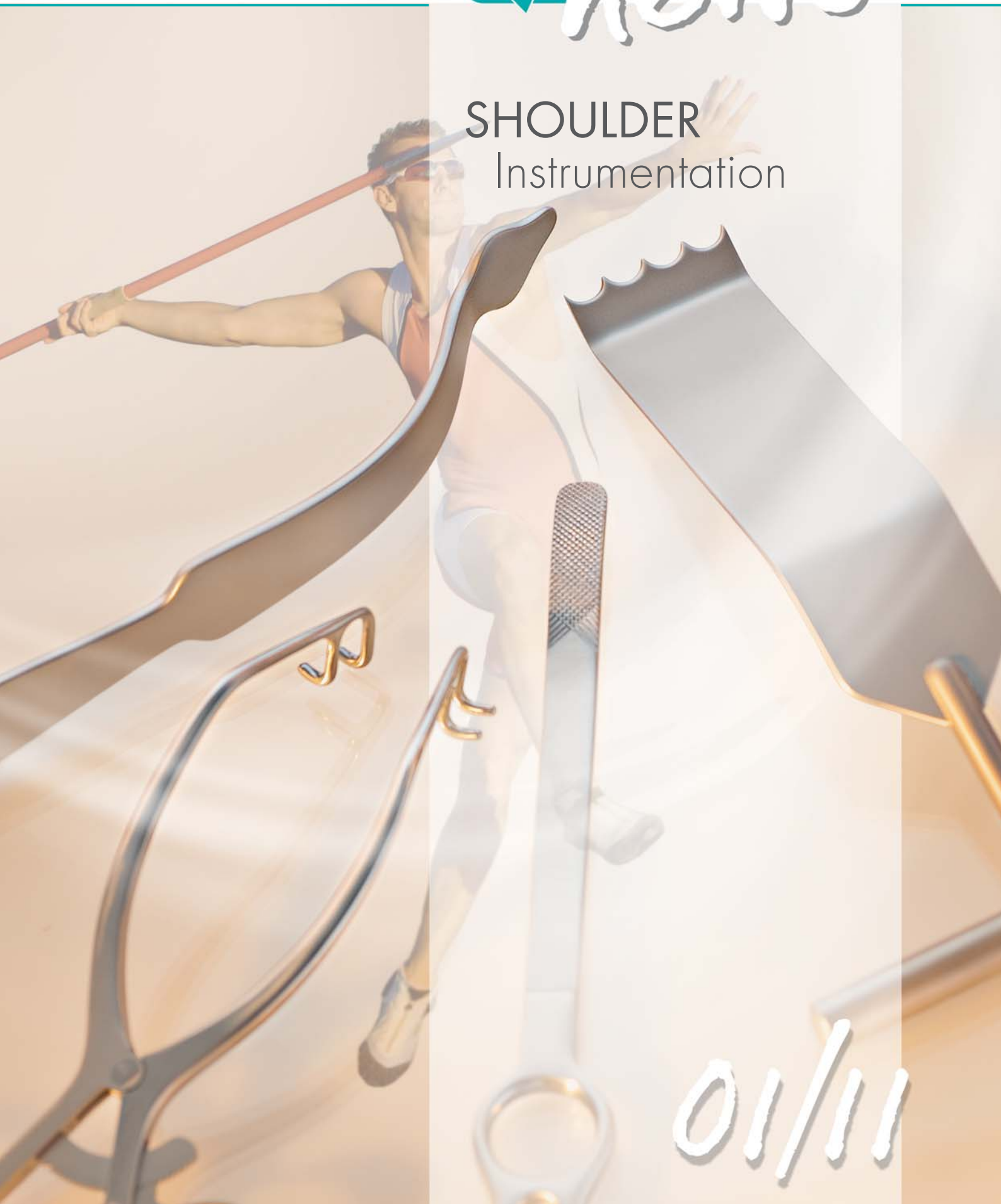

SHOULDER Instrumentation



01/11

Köbel Skin and Tissue Spreader with blunt tips

- | 259-257-016
Straight shaft, 1x1 teeth
- | 259-257-009
Angled shaft, 1x1 teeth
- | 259-257-006
Angled shaft, 2x2 teeth

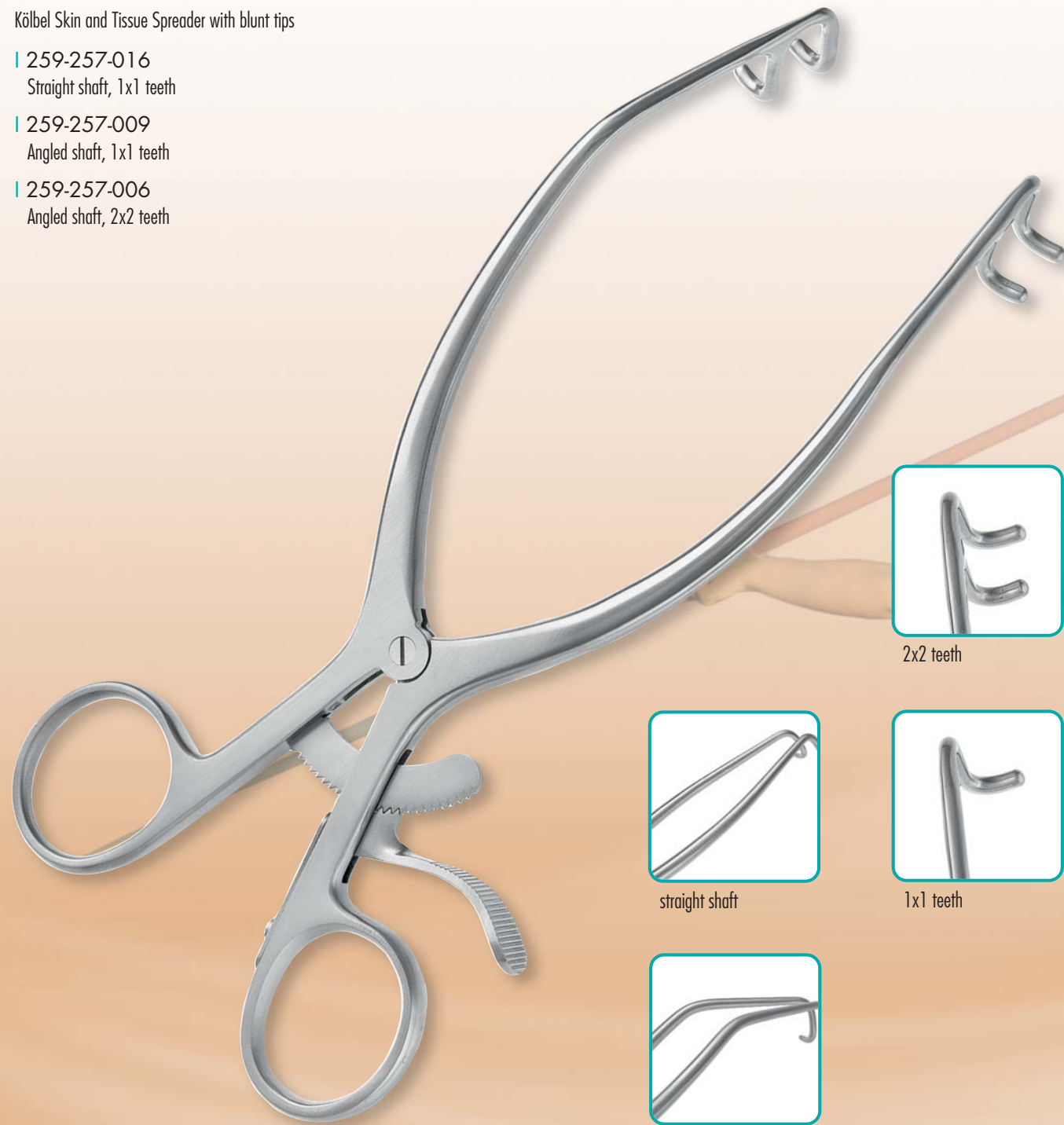

2x2 teeth

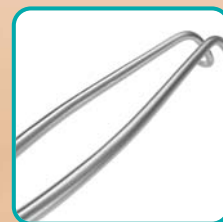

straight shaft



1x1 teeth



angled shaft



| 259-257-007 Köbel Capsule Retractor, blunt tips, 90° curved, 1 x 1 teeth

Köbel Self-Retaining Retractor Set with interchangeable Blades

- | 259-257-002
Self-Retaining Retractor, slightly angled, 20cm, 8"
for use with adaptable blades that can be
selected from below.



Pair of blades

259-257-003	36 x 36 mm
259-257-004	53 x 36 mm
259-257-005	68 x 36 mm
259-257-013	36 x 20 mm
259-257-014	53 x 20 mm
259-257-015	68 x 20 mm

SHOULDER INSTRUMENTATION



Middeldorpf Retractor
Handle Fig. 1
170-363-00X



170-363-001
170-325-001
21.5mm, 8¹/₂"
14x17mm



170-363-002
170-325-002
22mm, 8⁵/₈"
20x22mm



170-363-003
170-325-003
23.5mm, 9¹/₄"
26x30mm



Middeldorpf Retractor
Handle Fig. 2
170-325-00X



Richardson (Kelly) Retractor
24cm, 9¹/₂"



170-325-001
28x20mm



170-383-003
44x38mm



170-383-005
65x50mm

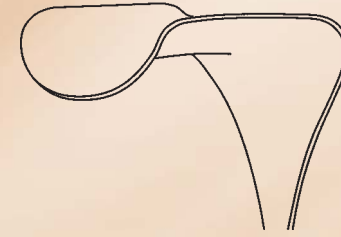

170-383-006
70x65mm



170-383-002
36x28mm

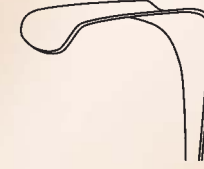

170-383-004
52x22mm

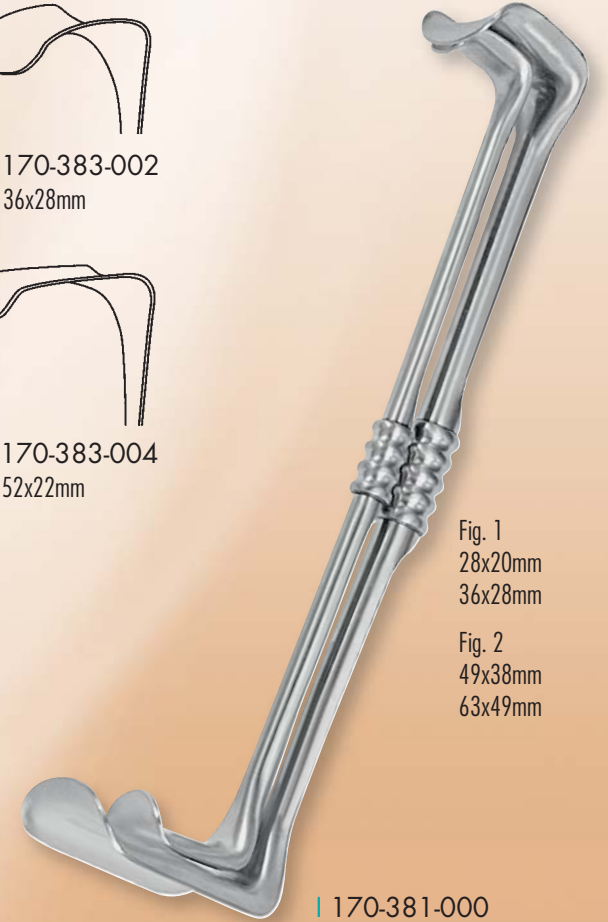

170-381-000
Richardson-Eastman
Retractor (Fig. 1 + 2)

170-381-001
Fig. 1
26cm, 10¹/₄"

170-381-002
Fig. 2
28cm, 11"

Fig. 1
28x20mm
36x28mm

Fig. 2
49x38mm
63x49mm



| 250-975-170
Inge lamina spreader, with teeth,
16.5cm, 6¹/₂"

| 250-975-230
With teeth, 24cm, 9¹/₂"



| 210-905-190
Bankhart Rotator Retractor,
19.0cm, ring left side

| 210-907-190
Bankhart Rotator Retractor,
19.0cm, ring right side

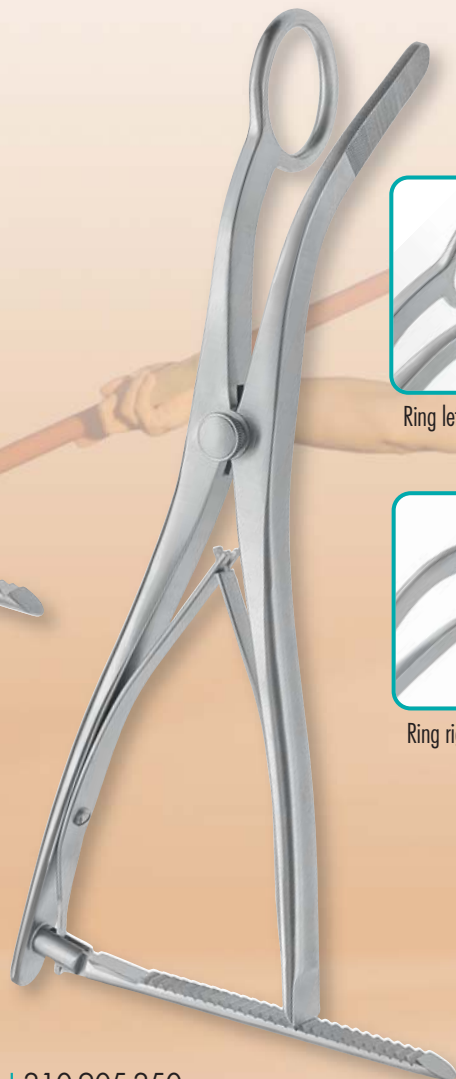

| 210-905-250
Bankhart Rotator Retractor,
25.0cm, ring left side

| 210-907-250
Bankhart Rotator Retractor,
25.0cm, ring right side



Ring left side



Ring right side



| 259-901-180
Fukuda Retraktor, small, 18cm, 7"
32mm blade



| 259-902-180
Fukuda Retraktor, large, 18cm, 7"
38mm blade



| 250-900-225
Fukuda-Kujat Retraktor, small,
22.5cm, 8³/₄", 30mm blade

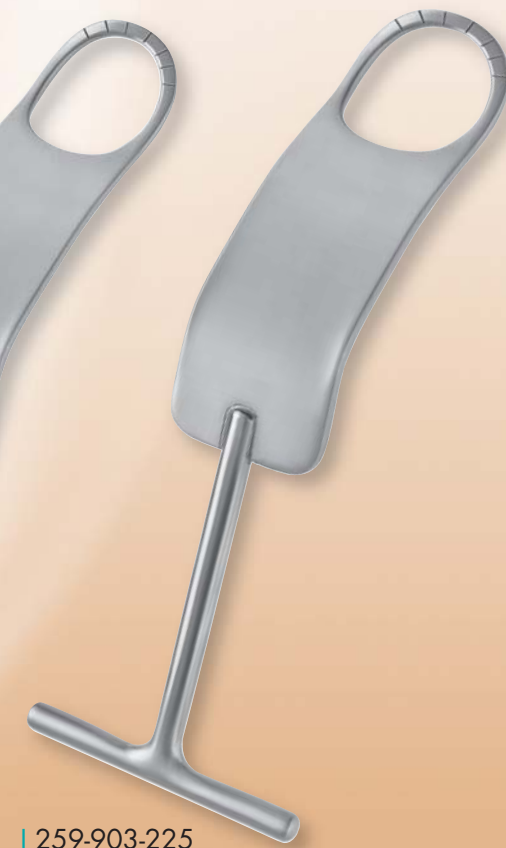

| 259-903-225
Fukuda-Kujat Retraktor, large,
22.5cm, 8³/₄", 35mm blade



Cloward Retractor Blade, 18cm, 7" overall length

259-260-001
70mm x 13mm blade

259-260-002
75mm x 18mm blade

259-260-003
75mm x 20mm blade

259-260-004
75mm x 23mm blade

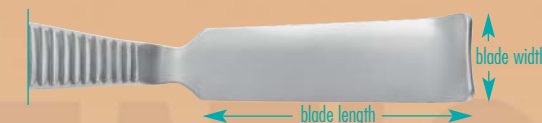

SHOULDER INSTRUMENTATION



Darrach Shoulder Elevator

| 259-260-009
9mm wide, 26.0cm,
10 1/4" overall length

| 259-260-012
12mm wide, 26.0cm,
10 1/4" overall length

| 259-260-016
16mm wide, 26.0cm,
10 1/4" overall length

| 259-260-020
20mm wide, 26.0cm,
10 1/4" overall length

| 259-260-025
25mm wide, 36.0cm,
14 1/8" overall length



Hook end

Kölbel Shoulder Elevator,
2 sharp prongs

| 210-537-281
15mm wide tip

| 210-537-282
20mm wide tip

| 210-537-283
15mm wide tip, with hook end

| 210-537-284
20mm wide tip, with hook end



smooth end

Kölbel Shoulder Elevator,
2 sharp prongs

| 210-537-285
18mm wide tip, slightly curved



| 259-258-422
Thin Glenoid Neck Retractor,
wide, 22mm wide tip,
28cm, 11" overall length

| 259-258-414
Thin Glenoid Neck Retractor,
Narrow, 14mm wide tip,
28cm, 11" overall length



Capsule Retractor for use in Bankhart
surgery, 25cm, 10" overall length

| 259-258-251
1 Prong

| 259-258-252
2 Prongs

| 259-258-253
3 Prongs



1 Prong



2 Prongs



3 Prongs



| 259-254-020
Bristow Bankart Capsule Retractor
with 2 teeth, 20mm, 10"



| 259-253-180
Bristow Bankart
Soft tissue retractor,
19cm, 7¹/₂"
with 3 blunt prongs,
21mm blade width

| 259-258-100
Anterior Glenoid Neck Retractor,
25mm wide tip, 28cm,
11" overall length

| 259-258-150
Agrawal Talon Retractor,
40.7mm wide tip, 20cm,
8" overall length

| 259-258-200
Posterior Glenoid Neck Retractor,
30mm wide blade, 25cm,
10" overall length

| 259-258-400
Goldstein Glenoid Neck Retractor,
18mm wide tip at teeth,
21.5cm, 8 1/2" overall length

| 259-258-600
Bhatman Humeral Head Retractor,
36mm wide blade, 25.5cm,
10" overall length

| 259-258-700
Skid Bone Elevator,
double ended, 28cm,
11" overall length

| 259-258-500
Humeral Head Retractor,
18cm, 7" overall length

SHOULDER INSTRUMENTATION

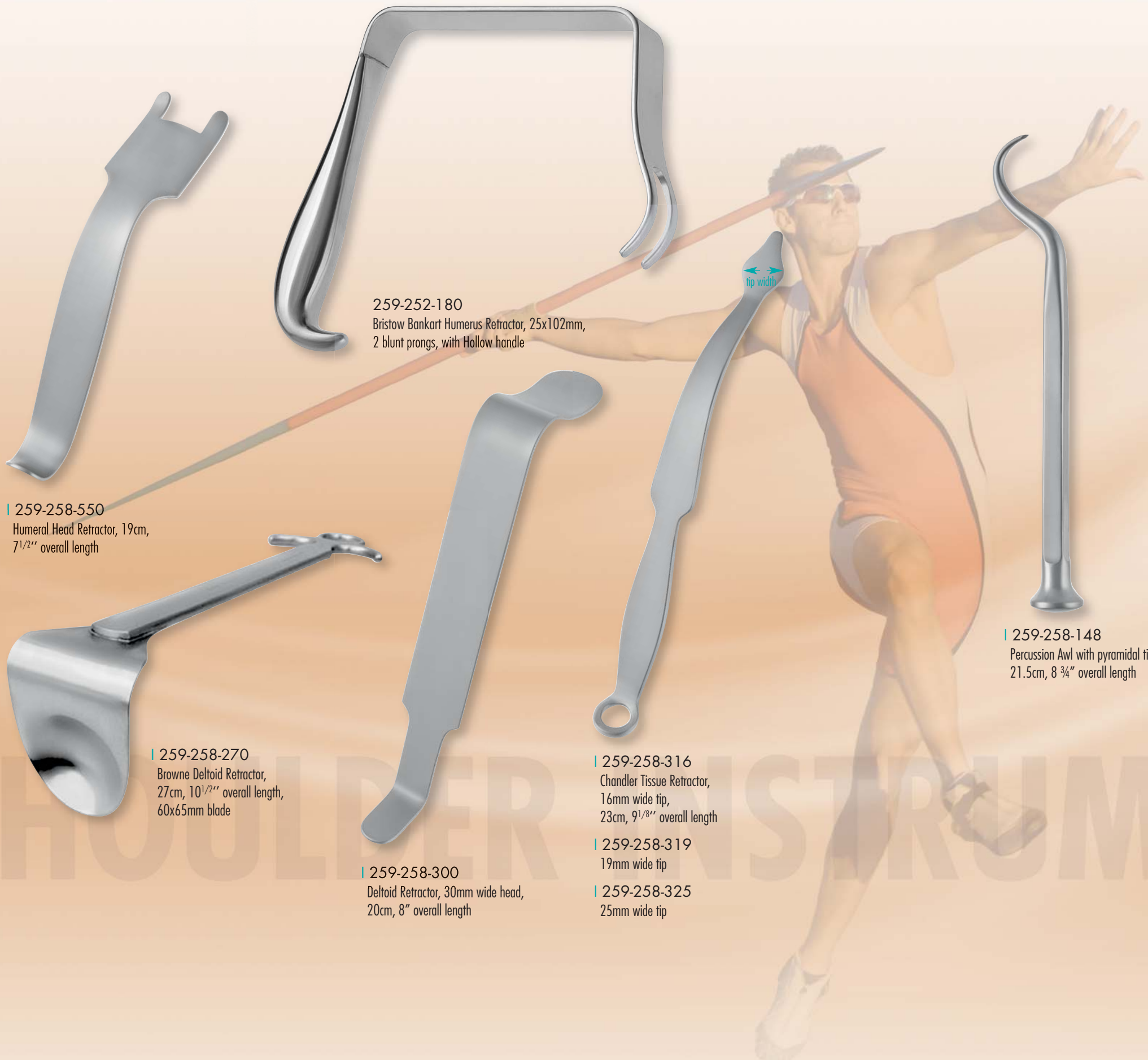

259-252-180
Bristow Bankart Humerus Retractor, 25x102mm,
2 blunt prongs, with Hollow handle

259-258-550
Humeral Head Retractor, 19cm,
7 1/2" overall length

259-258-270
Browne Deltoid Retractor,
27cm, 10 1/2" overall length,
60x65mm blade

259-258-300
Deltoid Retractor, 30mm wide head,
20cm, 8" overall length

259-258-316
Chandler Tissue Retractor,
16mm wide tip,
23cm, 9 1/8" overall length

259-258-319
19mm wide tip

259-258-325
25mm wide tip

259-258-148
Percussion Awl with pyramidal tip,
21.5cm, 8 3/4" overall length

259-258-145
Large Awl with pyramidal tip,
23.5cm, 9 1/4" overall length

259-258-144
Small Awl with pyramidal tip,
23.5cm, 9 1/4" overall length

259-258-146
Large Crochted Hook Awl,
23.5cm, 9 1/4" overall length

259-258-147
Small Crochted Hook Awl,
23.5cm, 9 1/4" overall length



Pyramidal tip



Crochted Hook

SHOULDER INSTRUMENTATION



| 210-130-000

| 210-130-001
Spare Screw



| 210-130-005
5mm, 8.5cm, 3 1/4"

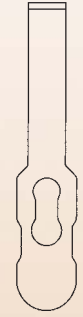

| 210-130-010
10mm, 8.5cm, 3 1/4"



| 210-130-016
16mm, 8.5cm, 3 1/4"

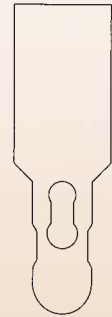

| 210-130-025
25mm, 8.5cm, 3 1/4"

Chisel blades



| 210-130-105
5mm, 8.5cm, 3 1/4"



| 210-130-110
10mm, 8.5cm, 3 1/4"



| 210-130-116
16mm, 8.5cm, 3 1/4"

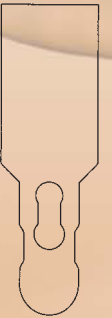

| 210-130-125
25mm, 8.5cm, 3 1/4"

Osteotome blades

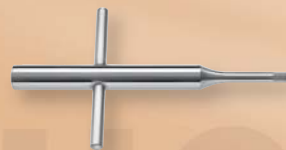

| 210-130-500
9cm, 3 1/2"
Wrench

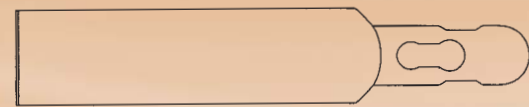

13,5cm, 5 3/8"

| 210-130-050
r=50mm

| 210-130-060
r=60mm

| 210-130-070
r=70mm

Gouge blades



Mallet with lead filling and
teflon handle, 260mm, 10 1/4"

| 210-260-150
150g, ø 35mm

| 210-260-240
240g, ø 45mm

| 210-260-330
330g, ø 50mm

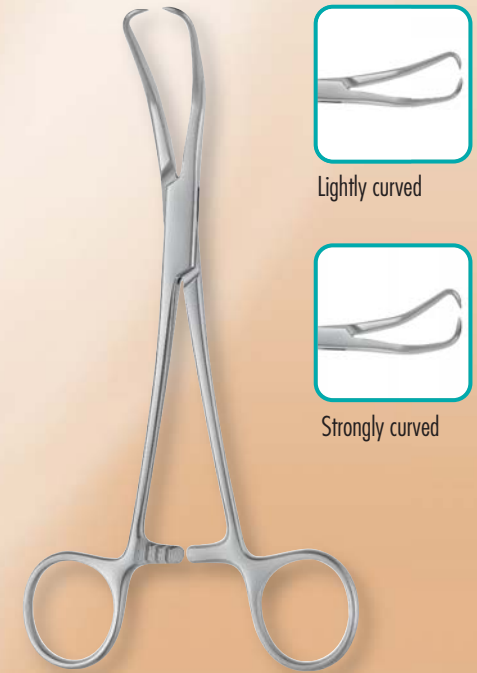

Lightly curved



Strongly curved

| 259-900-000
Bankart Perforating Forceps,
17cm, 6 3/4", lightly curved

| 259-900-001
Strongly curved

SHOULDER INSTRUMENTATION



| 210-900-185
Ruskin-Liston Bone Cutting Forceps,
straight, 18.5cm, 7 1/3"



| 210-901-185
Ruskin-Liston Bone Cutting Forceps,
curved, 18.5cm, 7 1/3"



| 210-880-175
McIndoe Bone cutting forceps,
15 mm wide, 17.5 cm, 7", straight

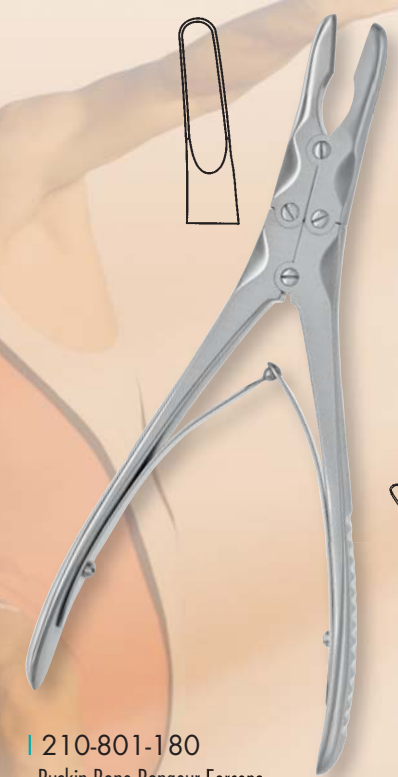

| 210-801-180
Ruskin Bone Rongeur Forceps,
5mm, curved, 18.0 cm, 7"



| 210-780-200
Marquard Bone Rongeur,
curved, 20cm, 7 3/4"



| 210-790-180
Beyer bone rongeur, 4mm
18.0 cm, 7", curved,
double action

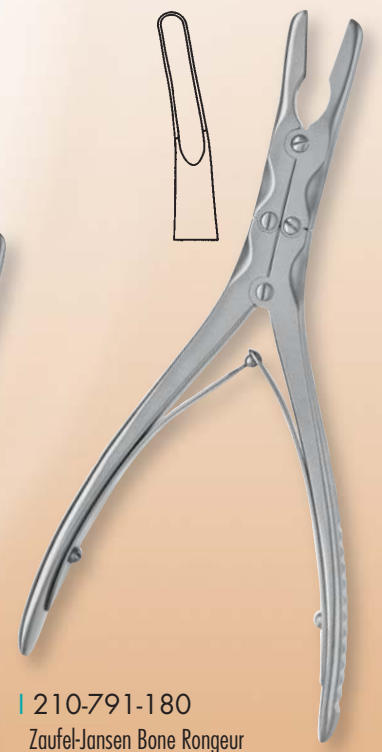

| 210-791-180
Zaufel-Jansen Bone Rongeur
18.0 cm, 7", curved,
double action pattern



| 259-255-180
Köbel Bone Rongeur,
strong curved, double action,
18.0cm, 7", 2.5mm to 5.0mm jaw



| 120-511-180
Metzenbaum Scissors
curved, TC, 17.5cm, 7"

| 120-511-200
20.3cm, 8"

| 120-511-230
23cm, 9"



| 121-111-180
Metzenbaum Scissors Supercut
18cm, 7"

| 121-111-200
20.3cm, 8"

| 121-111-230
23cm, 9"

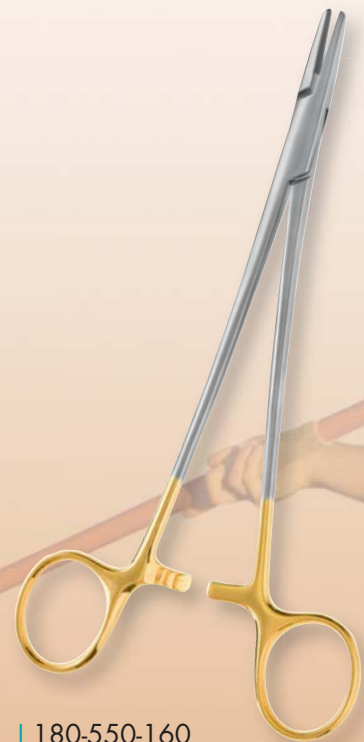

| 180-550-160
Mayo Hegar needle holder
16.0 cm, 6 1/4"

| 180-550-180
18cm, 7"

| 180-550-200
20.3cm, 8"

| 180-550-240
24cm, 9 1/2"



| 180-547-200
Heaney needle holder TC
20cm, 8", curved

| 180-547-240
24cm, 9 1/4"



| 180-548-180
De Bakey needle holder TC
18cm, 7", straight

| 180-548-200
20cm, 8"

| 180-548-230
23cm, 9"

| 180-548-260
26cm, 10 1/4"

| 180-548-310
31cm, 12 1/4"

| 180-548-370
37cm, 14 1/2"



| 130-143-180
Bonney Tissue Forceps
18cm, 7", 1x2 teeth



| 130-130-145
Lane Tissue Forceps
14.5cm, 5 3/4", 1x2 teeth



| 130-131-200
Lane Tissue Forceps
20cm, 8", 2x3 teeth

SHOULDER INSTRUMENTATION

